

Type PDC

Exhaust, Direct Drive, Hooded Power Roof Ventilator



P.O. Box 2300 Jacksonville, Florida 32203
 Phone: (904) 389-3646
 Fax: (904) 387-3449 • (904) 381-7560
 E-mail: info@coolair.com
 Internet: www.coolair.com

Abbreviations for Accessories

- DS – Safety disconnect switch (specify voltage)
- PFC1 – Surface mount prefabricated roof curb
- BS – Bird screen
- BDD – Automatic back draft damper
- MOD – Motorized back draft damper
- EPX – 6 mil epoxy finish
- HDG – Hot dip galvanized fan components
- CA – Cork-impregnated asphalt
- UC – Undercoating
- FG – Fiberglass insulation

Standard Fan Features

- Low profile
- Galvanized steel hood
- All-welded steel curb cap
- Low maintenance - no fan bearings or belts
- Adjustable pitch cast aluminum airfoil blades
- UL Listed for Standard 705 (most models)

Dimensions

Dimension A is the O.D. of the square hood.

Dimension B is the overall height above the curb.

Dimension C is the I.D. of the curb cap flange.

Dimension D is the inside curb minimum.

Dimension E is the maximum projection of the motor below top of curb for constant speed, 3-phase TEFC motor of maximum frame size for PRV size and style indicated. This dimension will vary with the type and HP of the motor actually selected.

Dimension F is the depth of the fan angle structure.

Dimension G is the curb cap flange.

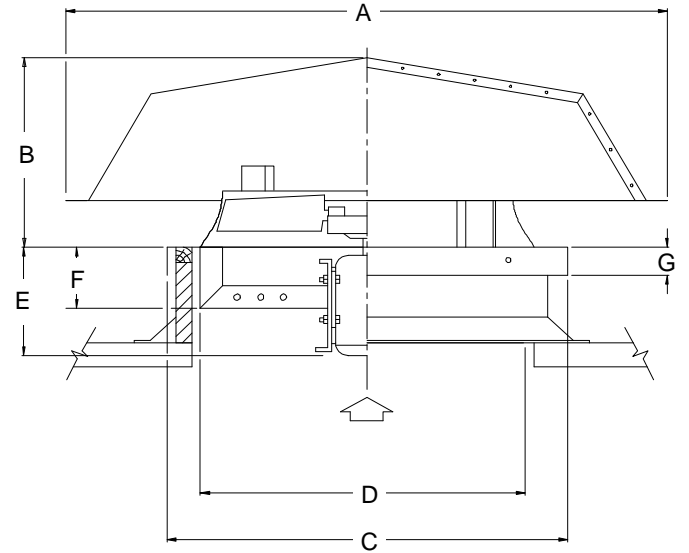

Dimensions in Inches							
Fan Size	A	B	C	D	E	F	G
24	57	23 1/4	38	32	12 3/8	5 1/8	2
30	57	23 1/4	44	38	13 3/4	5 1/8	2
36	67	27	50	44	15 1/4	5 1/8	2
42	78	28 3/4	56	50	15 1/4	5 1/8	2
48	88	29 3/4	62	56	19 3/8	6 5/8	2
54	98	35 1/4	68	62	19 3/4	6 5/8	2
60	109	42 1/4	77	69	20 3/4	7 5/8	3

Specifications

FAN NO.	QTY.	FAN DATA						MOTOR DATA					ENCLOSURE	ACCESSORIES AND REMARKS
		MODEL NO.	CFM	SP	RPM	SONES	HP	RPM	VOLTAGE	PH	HZ			

PROJECT _____ ENGINEER _____ SUBMITTED BY _____ DATE _____
 LOCATION _____ CONTRACTOR _____ APPROVED BY _____ DATE _____